

Liebert® MPH™

User Manual—North American & European Applications



TABLE OF CONTENTS

| | |
|---|-----------|
| IMPORTANT SAFETY INSTRUCTIONS | 1 |
| 1.0 INTRODUCTION | 3 |
| 1.1 General Characteristics | 4 |
| 1.1.1 North American Input / Output Systems | 4 |
| 1.1.2 European Input / Output Systems. | 4 |
| 2.0 INSTALLATION IN KNURR MIRACEL™ RACK—VERTICAL, ZERO-U MOUNT | 5 |
| 2.1 Mounting Hardware and Tools Required | 5 |
| 2.2 Install a Liebert MPH in a Knurr Miracel Rack | 5 |
| 2.3 Reposition Input Power Cord. | 7 |
| 3.0 INSTALLATION IN KNURR MIRACEL RACK—HORIZONTAL RACK-MOUNT. | 8 |
| 3.1 Mounting Hardware and Tools Required | 8 |
| 3.2 Install a Liebert MPH in a Knurr Miracel Rack | 8 |
| 3.2.1 Attach Mounting Brackets to the Liebert MPH | 8 |
| 3.2.2 Attach the Liebert MPH to Rack Rails | 8 |
| 4.0 INSTALLING OPTIONAL ITEMS | 9 |
| 4.1 RPC BDM—Basic Display Module | 9 |
| 4.2 Install an Optional RPC BDM in the Rack. | 9 |
| 4.2.1 Mounting Hardware | 9 |
| 4.2.2 RPC BDM Installation on Knurr Miracel Frame | 9 |
| 4.3 Temperature/Humidity Sensor Installation—Optional. | 10 |
| 5.0 USING THE LIEBERT MPH | 12 |
| 6.0 SPECIFICATIONS. | 13 |
| 6.1 Agency Approvals | 15 |
| 6.2 Product Warranty Registration. | 15 |

FIGURES

| | | |
|-----------|---|----|
| Figure 1 | Liebert MPH units—horizontal, 1U rack-mount and vertical, zero U mount. | 3 |
| Figure 2 | Attach brackets to the Liebert MPH | 5 |
| Figure 3 | Inserting a spring nut into a T-slot | 6 |
| Figure 4 | Attaching a Liebert MPH to a Knurr Miracel horizontal frame member | 6 |
| Figure 5 | Reposition input power cord. | 7 |
| Figure 6 | Liebert MPH ready for installation in a rack—horizontal-mount | 8 |
| Figure 7 | Rack-mounting the Liebert MPH. | 8 |
| Figure 8 | RPC BDM | 9 |
| Figure 9 | RPC BDM installation in rack | 10 |
| Figure 10 | RPC BDM cable connection port on Liebert RPC | 10 |
| Figure 11 | Temperature/humidity sensor mounting. | 11 |
| Figure 12 | Model number nomenclature | 14 |

TABLES

| | | |
|---------|--|----|
| Table 1 | Liebert MPH—Model numbers and specifications | 13 |
| Table 2 | Liebert MPH dimensions | 14 |

IMPORTANT SAFETY INSTRUCTIONS

SAVE THESE INSTRUCTIONS

This manual contains important safety instructions. Read all safety, installation and operating instructions before installing Liebert MPH power distribution units. Adhere to all warnings on the unit and in this manual. Follow all operating and user instructions. Individuals without previous training can install and operate this equipment.

- The Liebert MPH is designed for data processing equipment. The Liebert MPH is not intended for use with life support or other designated critical devices. If uncertain about its application, consult your local dealer or Emerson representative.
- Maximum load must not exceed that shown on the Liebert MPH rating label.
- Operate the Liebert MPH in an indoor environment only in an ambient temperature range of 32°F to +131°F (0°C to +55°C). Install it in a clean environment, free of conductive contaminants, moisture, flammable liquids, gases and corrosive substances.
- Liebert MPH power distribution units have no user-serviceable parts. Under no circumstances attempt to gain internal access due to the risk of electric shock or burn.
- Do not continue to use the Liebert MPH if the LED panel or monitoring interface indicators are not in accordance with these operating instructions. Refer all faults to your local dealer, Emerson representative or Emerson Network Power Applications Engineering.
- Never block or insert any object into the Liebert MPH.
- DO NOT CONNECT equipment that could overload the Liebert MPH.
- Refer to **6.0 - Specifications** to determine the electrical ratings and specifications of your Liebert MPH. It is imperative that the power supply and connections match the specifications of the unit being installed.



WARNING

Opening or removing the cover of a Liebert MPH may expose you to lethal voltages within the power distribution unit.

Observe all cautions and warnings in this manual. Failure to do so may result in serious injury or death.

Liebert MPH units contain no user-serviceable parts. For service, contact Emerson Network Power Applications Engineering or your local Emerson representative. Do not attempt to service this product yourself.

Never work alone.



CAUTION

Connecting your Liebert MPH and rack equipment to a power supply with an incorrect rating in voltage, amperes or phase may damage the connected equipment and your Liebert MPH.

If you have questions about the power supply connections, contact Emerson Network Power Applications Engineering or your local Emerson representative.



CAUTION

Shut down and unplug all equipment in your rack enclosure before beginning to connect equipment to your Liebert MPH.

When connecting the rack equipment to the Liebert MPH's receptacles, arrange cables and connections to avoid tangling and crisscrossing the power cables. For power management purposes, record the receptacle where each piece of equipment is connected. Receptacles on the Liebert MPH have a numerical designation. The Liebert MPH with more than one circuit has the outlets named with numbers and are grouped by branch with a number referring to the proper circuit breaker.

When connecting power to the Liebert MPH's receptacles, follow generally accepted procedures, such as routing the power cables separately from low-voltage communication and control wires to prevent electromagnetic interference.



CAUTION

All configuration steps must be completed before attempting to start equipment connected to the Liebert MPH.

Notice to European Union Customers: Disposal of Old Appliances

This product uses components that are dangerous for the environment, such as electronic cards and other electronic components. Any component that is removed must be taken to specialized collection and disposal centers. If this unit must be dismantled, this must be done by a specialized center for collection and disposal of electric and electronics appliances or other dangerous substances.

This product has been supplied from an environmentally aware manufacturer that complies with the Waste Electrical and Electronic Equipment (WEEE) Directive 2002/96/CE.

The “crossed-out wheelie bin” symbol at right is placed on this product to encourage you to recycle wherever possible. Please be environmentally responsible and recycle this product through your recycling facility at its end of life. Do not dispose of this product as unsorted municipal waste. Follow local municipal waste ordinances for proper disposal provisions to reduce the environmental impact of waste electrical and electronic equipment (WEEE).

For information regarding the scrapping of this equipment, please browse <http://www.eu.emersonnetworkpower.com> (“Products session” or “Contact us” session) or call our worldwide technical support at:

- 00 80011554499 (toll free number)
- +39 0298250222 (toll number based in Italy)

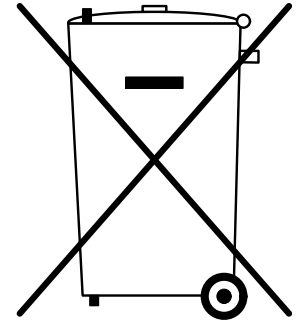

ROHS Compliance

The Liebert MPH modules comply with the Restriction of Hazardous Substances Directive (ROHS), prohibiting use of six hazardous materials manufacturing of electronics, including lead-free solder.

FCC Compliance

This unit complies with the limits for a Class A device pursuant to Part 15 of the FCC Rules. Operation is subject to the following two conditions:

- This device may not cause harmful interference, and
- This device must accept any interference received, including interference that may cause undesired operation.



NOTE

This equipment has been tested and found to comply with the limits for a Class A digital device, pursuant to part 15 of the FCC Rules. These limits are designed to provide reasonable protection against harmful interference when the equipment is operated in a commercial environment. This equipment generates, uses and can radiate radio frequency energy and, if not installed and used in accordance with the instruction manual, may cause harmful interference to radio communications. Operation of this equipment in a residential area is likely to cause harmful interference that the user must correct, including the expense of all corrective modifications.

1.0 INTRODUCTION

The Liebert MPH Series is a managed, single-phase or three-phase power distribution unit that offers monitoring only or monitoring along with receptacle control.

Liebert MPH units are available for mounting in either vertical, zero-U configuration and rack-mounting in standard, 19" enclosures. Vertical-mount units may have as many as 27 receptacles. The horizontal-mount units have up to nine receptacles. The output receptacles support equipment requiring connection with NEMA 5-20R, IEC60320-C13 and IEC60320-C19 plugs.

A Liebert MPH with single-phase input has a capacity up to 7.4kW (230VAC; 32A) or 3.6kW (120VAC; 30A). Three-phase input systems have a capacity up to 22.1kW (230/400VAC; 32A) or 10.7kW (120/208VAC; 30A). For further details, refer to **6.0 - Specifications**.

Remote monitoring is enabled by the included communication card, the Liebert RPC™, which permits managing the Liebert MPH over a secure Web page and SNMP-based network management system. The Liebert RPC permits interconnecting multiple Liebert MPH units and connecting Liebert MPH with other units for monitoring and management.

A Liebert MPH can be monitored locally with an RPC BDM™, an optional display module that connects directly to the communication card. The monitoring unit can be handheld, mounted in or on the rack or mounted on a nearby wall.

Multiple Liebert MPHs can be centrally managed with Liebert Nform™, which adds group-based receptacle management.

Figure 1 Liebert MPH units—horizontal, 1U rack-mount and vertical, zero U mount

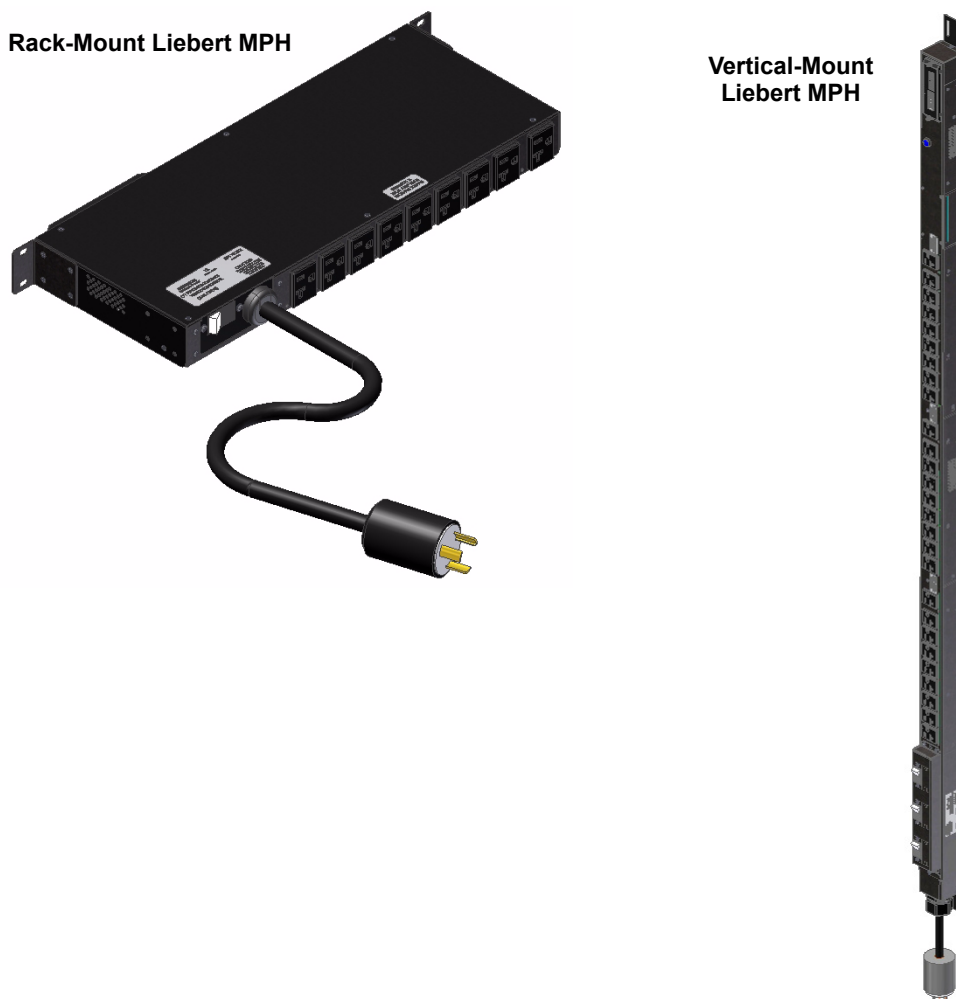

1.1 General Characteristics

- Input current 16 to 32A
- Single-phase and three-phase power input
- Input voltages 120VAC, 120/208VAC, 208VAC, 230VAC, 230/400VAC, 240VAC
- Line-to-Line and Line-to-Neutral
- Output Receptacles: NEMA and IEC
- Input connection by hard-wired cords, 10 feet (3m) long
- Input power cord plugs: L5-20P, L5-30P, L6-20P, L6-30P, L21-30P, IEC-C20, IEC309 3-wire 32A, IEC309 5-wire 32A

For details, refer to **6.0 - Specifications**. Refer to **Table 2** for the dimensions.

1.1.1 North American Input / Output Systems

120VAC, Single-Phase Input - Vertical-Mount

L5-20P or L5-30P plug connection, 10 ft. (3m) input power cord, 20 or 30A; 5-20R (T-blade) receptacles, 27 outlets; 68.25 in. (1735mm) long

120VAC, Single-Phase Input / Output - Rack-Mount

L5-20P or L5-30P plug connection, 10 ft. (3m) input power cord, 20 or 30A; 5-20R (T-blade) receptacles, 9 outlets; 1U tall

200-240VAC, Single-Phase Input / Output - Vertical-Mount

L6-20P or L6-30P plug connection, 10 ft. (3m) input power cord, 20 or 30A, 27 IEC-C13 or 21 IEC-C13 plus 6 IEC-C19; 68.25 in (1735mm) long

200-240VAC, Single-Phase Input / Output - Rack-Mount

L6-20P or L6-30P plug connection, 10 ft. (3m) input power cord, 20 or 30A; IEC-C13 receptacles, 9 outlets; 1U tall

120/208VAC, Three-Phase Input / 208 & 120VAC Output - Vertical-Mount

L21-30P or L15-30P plug connection, 10 ft. (3m) input power cord, 20 or 30A; 27 IEC-C13 or 21 IEC-C13 plus 6 IEC-C19 or 21 IEC-C13 plus 6 5-20R receptacles, 27 outlets; 68.25 in. (1735mm) long

1.1.2 European Input / Output Systems

230VAC, Single-Phase Input / Output - Vertical-Mount

IEC-C20 or IEC-309 plug connection, 3m (10 ft.) input power cord, 16 or 32A, 27 IEC-C13 or 21 IEC-C13 plus 6 IEC-C19; 68.25 in (1735mm) long

230VAC, Single-Phase Input / Output - Rack-Mount

IEC-C20 or IEC-309 plug connection, 3m (10 ft.) input power cord, 16 or 32A; IEC-C13 receptacles, 9-outlets; 1U tall

400VAC, Three-Phase Input / 230VAC Output - Vertical-Mount

IEC-309 plug connection, 3m (10 ft.) input power cord, 20 or 30A; 27 IEC-C13 or 21 IEC-C13 plus 6 IEC-C19 receptacles, 27 outlets; 1735mm (68.25 in.) long

2.0 INSTALLATION IN KNURR MIRACEL™ RACK—VERTICAL, ZERO-U MOUNT

A Liebert MPH can be installed in a Knurr Miracel rack on the frame members using field-supplied Knurr hardware. The unit can be installed on the face or the side of frame members.

2.1 Mounting Hardware and Tools Required

Factory-Supplied

- Brackets: 2
- Screws, 6-32 x 1/4": 8

Field-Supplied

- Spring-nuts, supplied with Knurr rack
- Tool-less fasteners, supplied with Knurr rack
- Phillips screwdriver

2.2 Install a Liebert MPH in a Knurr Miracel Rack

Determine where in the Knurr Miracel the Liebert MPH will be installed and follow the applicable instructions below. Installation requires attaching two brackets to the Liebert MPH, inserting four spring nuts into the rack and using the brackets to attach the Liebert MPH to the rack. Refer to **Figures 2, 3** and **4**. (Refer to **Table 2** for the dimensions of the Liebert MPH.)

The bracket is intended for attaching the Liebert MPH to the face of a frame member.

1. Use four of the 6-32 screws to attach a bracket to each end of the Liebert MPH. The supplied brackets have four holes that match holes on each end of the Liebert MPH.
 - If mounting on horizontal frame members, attach the brackets in-line, as shown in the left side of **Figure 2**.
 - If mounting on an upright frame member, attach the brackets at a right angle to the Liebert MPH as shown in the right side of **Figure 2**.
2. Tighten the screws firmly.
3. Insert two spring nuts into the appropriate T-slot on the frame member.

Position the spring nuts to accommodate screws inserted through slots in the brackets. To move the spring nuts, press down on each with a small, pointed object and slide each into position.
4. Hold the Liebert MPH in place and attach the top of the unit to the rack with tool-less fasteners.
5. Tighten the screws firmly.
6. Repeat **Steps 3** through **5** for the lower bracket on the lower end of the Liebert MPH.

Figure 2 Attach brackets to the Liebert MPH



**In-Line Bracket
Attachment on Liebert MPH
(used for mounting on horizontal
frame members)**



**90-Degree Bracket
Attachment on Liebert MPH
(used for mounting on an upright
frame member)**

Figure 3 Inserting a spring nut into a T-slot

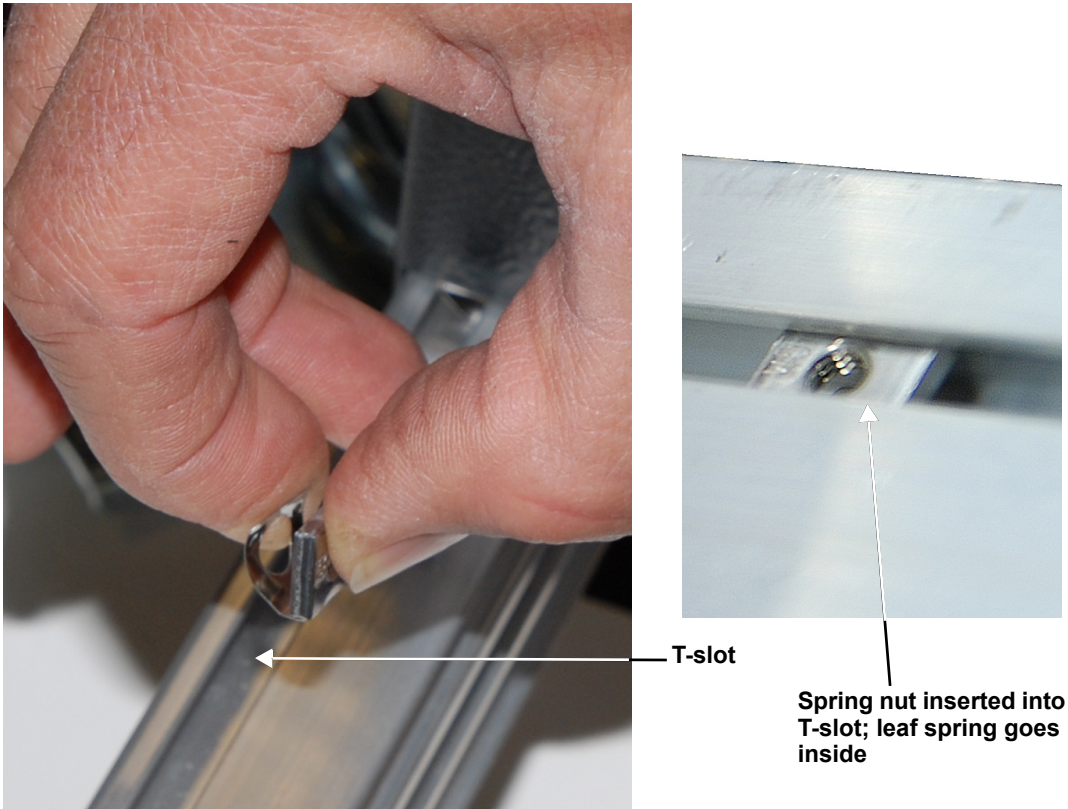

Figure 4 Attaching a Liebert MPH to a Knurr Miracel horizontal frame member



2.3 Reposition Input Power Cord

The Liebert MPH is shipped from the factory with the input power cord entering from the end of the unit. The cord can be repositioned if it will need to enter from the front. To reposition the cord:

1. Remove the four screws retaining the input power plate.
2. Reposition so that power cord enters from front.
3. Reinstall the screws and tighten them.

Figure 5 Reposition input power cord

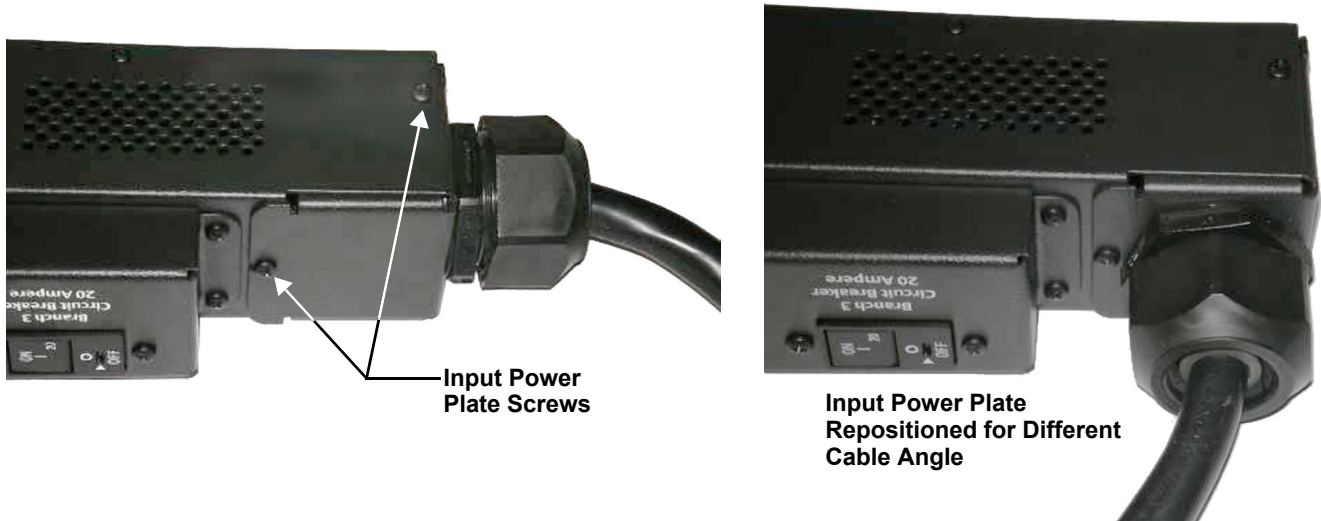

3.0 INSTALLATION IN KNURR MIRACEL RACK—HORIZONTAL RACK-MOUNT

A Liebert MPH can be installed in a Knurr Miracel rack in only 1U of equipment space using field-supplied Knurr hardware.

3.1 Mounting Hardware and Tools Required

Factory-Supplied

- L-shaped bracket: 2
- Screws, 6-32 x 1/4": 8

Field-Supplied

- Phillips screwdriver

3.2 Install a Liebert MPH in a Knurr Miracel Rack

3.2.1 Attach Mounting Brackets to the Liebert MPH

Before attaching the horizontal-mount brackets to the Liebert MPH, determine whether to attach the brackets to the front edge or rear edge of the unit. This will depend, in part, on whether the Liebert MPH would be best placed in the front of the rack or in the rear for routing power and communication wires. Bracket location also determines whether the Liebert MPH display is viewed from the front or rear of the rack.

When mounting the Liebert MPH, position the unit for ease of access and clearance. (Refer to **Table 2** for the dimensions of the Liebert MPH.)

To attach the brackets:

1. Hold one mounting bracket against the side of the Liebert MPH, making sure that the end of the bracket with the round holes is against the unit.
2. Attach the bracket to the unit with four Phillips head screws, tightening them firmly.
3. Repeat **Steps 1** and **2** for the bracket on the opposite side of the Liebert MPH.

Figure 6 Liebert MPH ready for installation in a rack—horizontal-mount

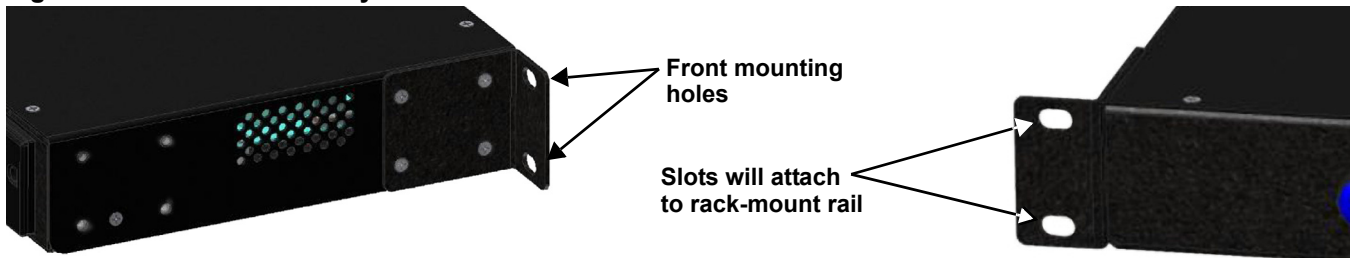

3.2.2 Attach the Liebert MPH to Rack Rails

Determine where the Liebert MPH would be best placed in the rack for routing power and communication wires.

The rack-mount Liebert MPH is installed horizontally in standard rack face position on the rails using the square, EIA-spaced holes. They use four captive nuts snapped into the rail holes and four screws to attach the Liebert MPH brackets to the rail.

As with all Liebert rack-mount equipment, obtain the appropriate size rack-mounting hardware kit for captive nuts and screws.

Figure 7 Rack-mounting the Liebert MPH
Screws go through bracket holes, through rail and insert into the captive nuts

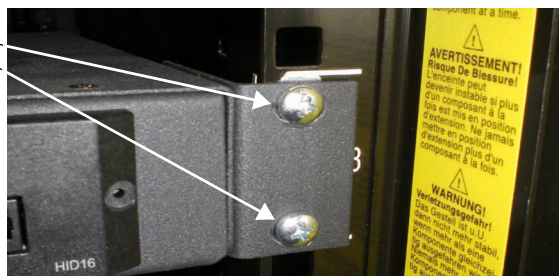

4.0 INSTALLING OPTIONAL ITEMS

4.1 RPC BDM—Basic Display Module

The RPC BDM provides local display of electrical status for all connected Liebert MPH systems. Display information is accessed via a navigation switch on the RPC BDM. The RPC BDM is cable-connected to the Liebert RPC allowing the user to locate the display to suit the local reading requirements. A 2-meter cable and general mounting provisions are provided. A single display can be used for up to four Liebert MPH connected in a Rack PDU Array™.

Figure 8 RPC BDM



4.2 Install an Optional RPC BDM in the Rack

The RPC BDM (Basic Display Module) can be mounted in the rack with either the included hardware or with a cable tie through the slot on the back of the module (see **Figure 9**). Either method permits moving the RPC BDM to a different place in the same rack or to another rack.

4.2.1 Mounting Hardware

- Spring nut M5: 1
- Spacer sleeve: 1
- Special MPH screw: 1
- Cable clip: 1

Tools Required

- Flat-blade screwdriver

4.2.2 RPC BDM Installation on Knurr Miracel Frame

1. Determine the mounting location in the rack.
2. Insert a spring nut into a T-slot on the frame member where the RPC BDM will be installed (refer to **Figure 3**).
3. Insert the Liebert MPH screw into the spacer sleeve.
4. Insert the Liebert MPH screw into the spring nut and tighten securely with the screwdriver.
5. Hang the RPC BDM on the Liebert screw with the hooded mounting slot on the back of the RPC BDM (see **Figure 9**).
6. Connect the RPC BDM to the Liebert RPC with an Ethernet cable.
Be certain to connect the cable to the correct port on the Liebert RPC (see **Figure 10**).

Figure 9 RPC BDM installation in rack

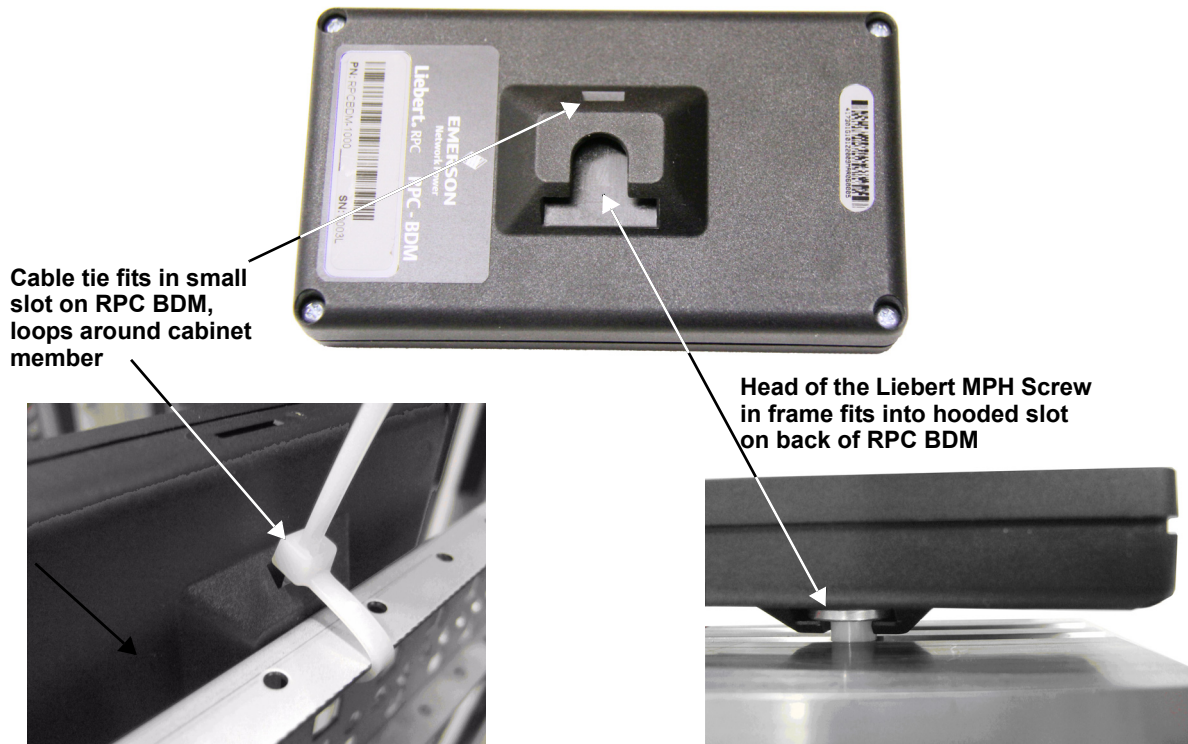
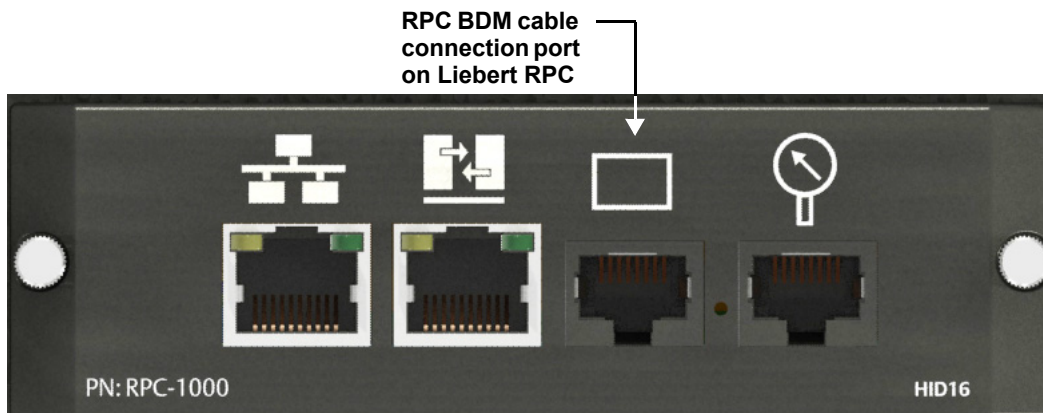

Figure 10 RPC BDM cable connection port on Liebert RPC



4.3 Temperature/Humidity Sensor Installation—Optional

Optional Liebert SN temperature/humidity sensors are available to assist in monitoring conditions in the rack. Liebert SN sensors are designed for installation in a Knurr Miracel without tools, but each may be placed in any area to monitor temperature and humidity levels. Each connects to the Liebert RPC, which makes readings available to Liebert monitoring methods.

Only one mounting method is addressed in this manual: attaching a single sensor with a bracket to a Knurr Miracel frame member. For details on other mounting locations and methods, refer to the Liebert SN quick-start guide, SL-20840, or to the Liebert RPC user manual, SL-20825. Each is available at Liebert's Web site, www.liebert.com

To install a sensor on a Knurr Miracel frame member:

1. Assemble the Liebert SN and sensor bracket:
 - a. Insert the sensor bracket base into one end of the sensor support as shown in **Figure 11**.
 - b. Snap the sensor into the other end of the sensor support.
2. Choose where in the rack to install the sensor assembly. Emerson recommends placing the sensor in the area that is likely to be warmest.
3. Hold the sensor bracket on a T-slot on the Knurr Miracel frame where the sensor will be placed.
4. Insert the included quarter-turn fastener through the rectangular hole in the sensor bracket base and into the T-slot (see **Figure 11**).
5. Turn the fastener clockwise 90 degrees, a quarter of a turn.
6. Route the sensor cable to the Liebert RPC and insert it into the card's external sensor port.
For further details, refer to the Liebert RPC user manual, SL-20825, which shipped with the card and is available at Liebert's Web site: www.liebert.com

Figure 11 Temperature/humidity sensor mounting

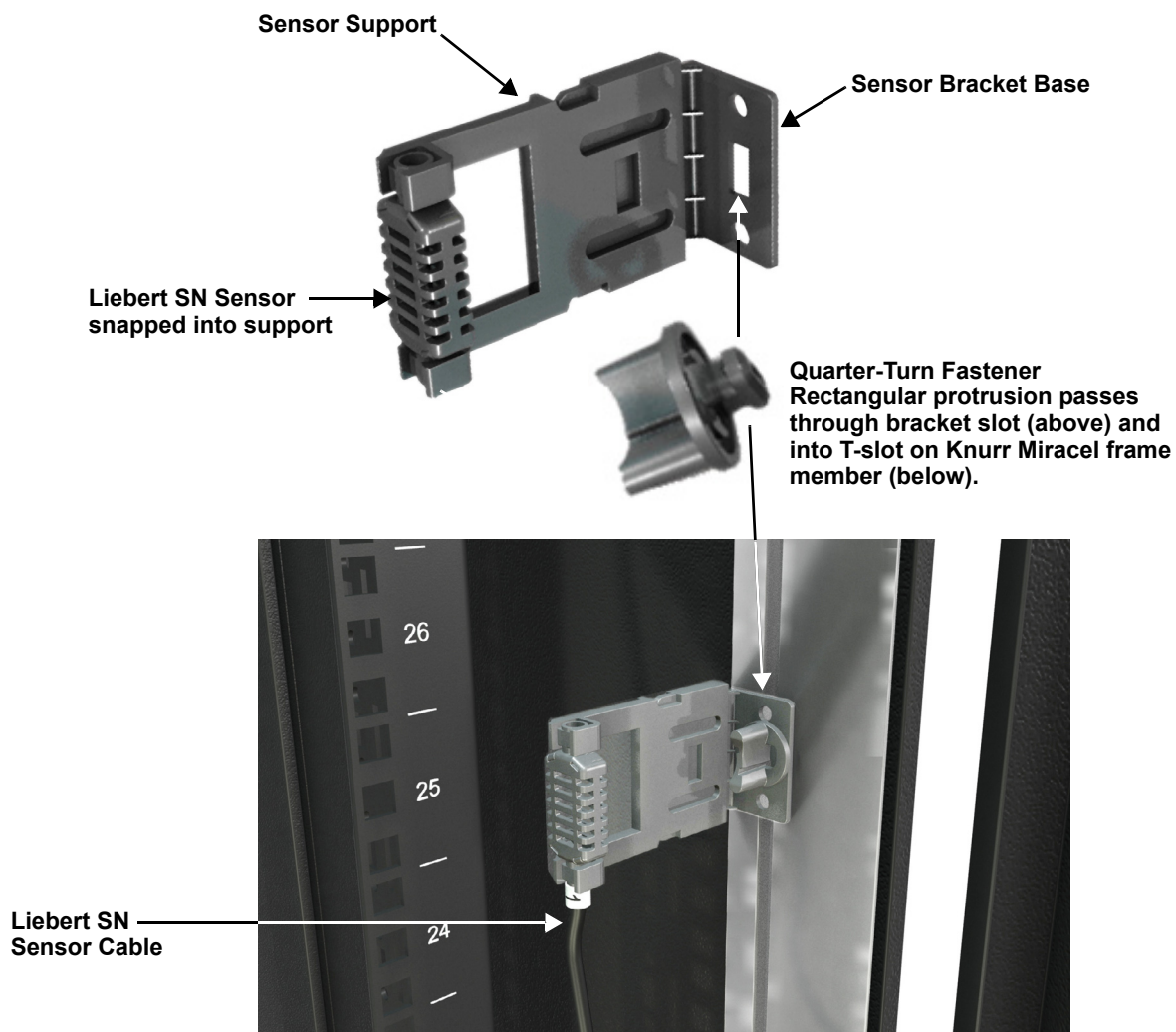

5.0 USING THE LIEBERT MPH

The Liebert MPH is ready for service after it has been installed in the rack and equipment has been connected to the output sockets. Refer to the Liebert RPC user manual, SL-20825, available at the Liebert Web site, for full details on controlling and monitoring the Liebert MPH: www.liebert.com

Emerson recommends following these steps when starting a newly installed Liebert MPH:

1. Shut down and unplug all equipment in the rack from input power sources.
2. If the Liebert MPH will be monitored over a network, connect an Ethernet cable to the network port on the factory-installed Liebert RPC (for details, refer to the Liebert RPC manual, SL-20825, available at the Liebert Web site: www.liebert.com).
3. Connect input power to the Liebert MPH.
4. Route the rack equipment's power cables to the Liebert MPH, following proper procedures and good practices, such as segregating power cables from control cables and keeping cable bends to recommended angles.
5. Connect the rack equipment's input power cables to the Liebert MPH, recording where each piece of rack equipment is connected, using the receptacle numbers on the Liebert MPH.
6. Post the connection information on or near the rack and at any remote monitoring location
7. Switch On the connected rack equipment one piece at a time and verify that each is operating properly.
8. Monitor and control the Liebert MPH as detailed in the Liebert RPC manual, SL-20825, available at the Liebert Web site: www.liebert.com

6.0 SPECIFICATIONS

Table 1 Liebert MPH—Model numbers and specifications

| Part Number | Input | | | | | | Output | | Form Factor |
|--------------------------------------|---------|------------|----------------------|------|-------|-------------|--------------------------------------|------------|-------------|
| | Voltage | Rated Amps | Max. Continuous Amps | kW | Phase | Plug | Receptacle/Socket Configuration | | |
| Monitoring Level - Basic | | | | | | | | | |
| North American Applications | | | | | | | | | |
| MPH-NBV27NXXH30 | 208/120 | 30 | 24 | 8.6 | 3 | NEMA L21-30 | (27) IEC-C13 | Vertical | |
| MPH-NBV27NXXF30 | 208-240 | 30 | 24 | 4.9 | 1 | NEMA L6-30 | (27) IEC-C13 | Vertical | |
| MPH-NBV27NXXE30 | 208-240 | 20 | 16 | 3.3 | 1 | NEMA L6-20 | (27) IEC-C13 | Vertical | |
| MPH-NBV27NOXH30 | 208/120 | 30 | 24 | 8.6 | 3 | NEMA L21-30 | (21) IEC-C13 & (6) IEC-C19 | Vertical | |
| MPH-NBV27NOXF30 | 208-240 | 30 | 24 | 4.9 | 1 | NEMA L6-30 | (21) IEC-C13 & (6) IEC-C19 | Vertical | |
| MPH-NBV27AXXH30 | 208/120 | 30 | 24 | 8.6 | 3 | NEMA L21-30 | (27) NEMA 5-20R T-Slot | Vertical | |
| MPH-NBV27AXXD30 | 120 | 30 | 24 | 2.8 | 1 | NEMA L5-30 | (27) NEMA 5-20R T-Slot | Vertical | |
| MPH-NBV27AXXC30 | 120 | 20 | 16 | 1.9 | 1 | NEMA L5-20 | (27) NEMA 5-20R T-Slot | Vertical | |
| MPH-NBV27ANXH30 | 208/120 | 30 | 24 | 8.6 | 3 | NEMA L21-30 | (21) IEC-C13 & (6) NEMA 5-20R T-Slot | Vertical | |
| MPH-NBR09NXXF30 | 208-240 | 30 | 24 | 4.9 | 1 | NEMA L6-30 | (9) IEC-C13 | Rack mount | |
| MPH-NBR09NXXE30 | 208-240 | 20 | 16 | 3.3 | 1 | NEMA L6-20 | (9) IEC-C13 | Rack mount | |
| MPH-NBR09AXXD30 | 120 | 30 | 24 | 2.8 | 1 | NEMA L5-30 | (9) NEMA 5-20R T-Slot | Rack mount | |
| MPH-NBR09AXXC30 | 120 | 20 | 16 | 1.9 | 1 | NEMA L5-20 | (9) NEMA 5-20R T-Slot | Rack mount | |
| European Applications | | | | | | | | | |
| MPH-EBV27NXXR30 | 400/230 | 32 | 32 | 12.8 | 3 | IEC-309 | (27) IEC-C13 | Vertical | |
| MPH-EBV27NXXQ30 | 230 | 32 | 32 | 7.3 | 1 | IEC-309 | (27) IEC-C13 | Vertical | |
| MPH-EBV27NXXO30 | 230 | 16 | 16 | 3.6 | 1 | IEC-C20 | (27) IEC-C13 | Vertical | |
| MPH-EBV27NOXR30 | 400/230 | 32 | 32 | 12.8 | 3 | IEC-309 | (21) C-13 & (6) C-19 | Vertical | |
| MPH-EBV27NOXQ30 | 230 | 32 | 32 | 7.3 | 1 | IEC-309 | (21) C-13 & (6) C-19 | Vertical | |
| MPH-EBV27NOXO30 | 230 | 16 | 16 | 3.6 | 1 | IEC-C20 | (21) C-13 & (6) C-19 | Vertical | |
| MPH-EBR09NXXQ30 | 230 | 32 | 32 | 7.3 | 1 | IEC-309 | (9) IEC-C13 | Rack mount | |
| MPH-EBR09NXXO30 | 230 | 16 | 16 | 3.6 | 1 | IEC-C20 | (9) IEC-C13 | Rack mount | |
| Monitoring Level - Controlled | | | | | | | | | |
| North American Applications | | | | | | | | | |
| MPH-NCV27NXXH30 | 208/120 | 30 | 24 | 8.6 | 3 | NEMA L21-30 | (27) IEC-C13 | Vertical | |
| MPH-NCV27NXXF30 | 208-240 | 30 | 24 | 4.9 | 1 | NEMA L6-30 | (27) IEC-C13 | Vertical | |
| MPH-NCV27NXXE30 | 208-240 | 20 | 16 | 3.3 | 1 | NEMA L6-20 | (27) IEC-C13 | Vertical | |
| MPH-NCV27NOXH30 | 208/120 | 30 | 24 | 8.6 | 3 | NEMA L21-30 | (21) IEC-C13 & (6) IEC-C19 | Vertical | |
| MPH-NCV27NOXF30 | 208-240 | 30 | 24 | 4.9 | 1 | NEMA L6-30 | (21) IEC-C13 & (6) IEC-C19 | Vertical | |
| MPH-NCV27AXXH30 | 208/120 | 30 | 24 | 8.6 | 3 | NEMA L21-30 | (27) NEMA 5-20R T-Slot | Vertical | |
| MPH-NCV27AXXD30 | 120 | 30 | 24 | 2.8 | 1 | NEMA L5-30 | (27) NEMA 5-20R T-Slot | Vertical | |
| MPH-NCV27AXXC30 | 120 | 20 | 16 | 1.9 | 1 | NEMA L5-20 | (27) NEMA 5-20R T-Slot | Vertical | |
| MPH-NCV27ANXH30 | 208/120 | 30 | 24 | 8.6 | 3 | NEMA L21-30 | (21) IEC-C13 & (6) NEMA 5-20R T-Slot | Vertical | |
| MPH-NCR09NXXF30 | 208-240 | 30 | 24 | 4.9 | 1 | NEMA L6-30 | (9) IEC-C13 | Rack mount | |
| MPH-NCR09NXXE30 | 208-240 | 20 | 16 | 3.3 | 1 | NEMA L6-20 | (9) IEC-C13 | Rack mount | |
| MPH-NCR09AXXD30 | 120 | 30 | 24 | 2.8 | 1 | NEMA L5-30 | (9) NEMA 5-20R T-Slot | Rack mount | |
| MPH-NCR09AXXC30 | 120 | 20 | 16 | 1.9 | 1 | NEMA L5-20 | (9) NEMA 5-20R T-Slot | Rack mount | |
| European Applications | | | | | | | | | |
| MPH-ECV27NXXR30 | 400/230 | 32 | 32 | 12.8 | 3 | IEC-309 | (27) IEC-C13 | Vertical | |
| MPH-ECV27NXXQ30 | 230 | 32 | 32 | 7.3 | 1 | IEC-309 | (27) IEC-C13 | Vertical | |
| MPH-ECV27NXXO30 | 230 | 16 | 16 | 3.6 | 1 | IEC-C20 | (27) IEC-C13 | Vertical | |
| MPH-ECV27NOXR30 | 400/230 | 32 | 32 | 12.8 | 3 | IEC-309 | (21) C-13 & (6) C-19 | Vertical | |
| MPH-ECV27NOXQ30 | 230 | 32 | 32 | 7.3 | 1 | IEC-309 | (21) C-13 & (6) C-19 | Vertical | |
| MPH-ECV27NOXO30 | 230 | 16 | 16 | 3.6 | 1 | IEC-C20 | (21) C-13 & (6) C-19 | Vertical | |
| MPH-ECR09NXXQ30 | 230 | 32 | 32 | 7.3 | 1 | IEC-309 | (9) IEC-C13 | Rack mount | |
| MPH-ECR09NXXO30 | 230 | 16 | 16 | 3.6 | 1 | IEC-C20 | (9) IEC-C13 | Rack mount | |

Table 2 Liebert MPH dimensions

| Vertical-Mount W x D x H, in. (mm) | Rack-Mount W x D x H, in. (mm) |
|--|---|
| 1.97 x 3.13 x 68.1 (50 x 80 x 1730) | 17.25 x 7.0 x 1.73 (438 x 178 x 44 mm) |

Figure 12 Model number nomenclature

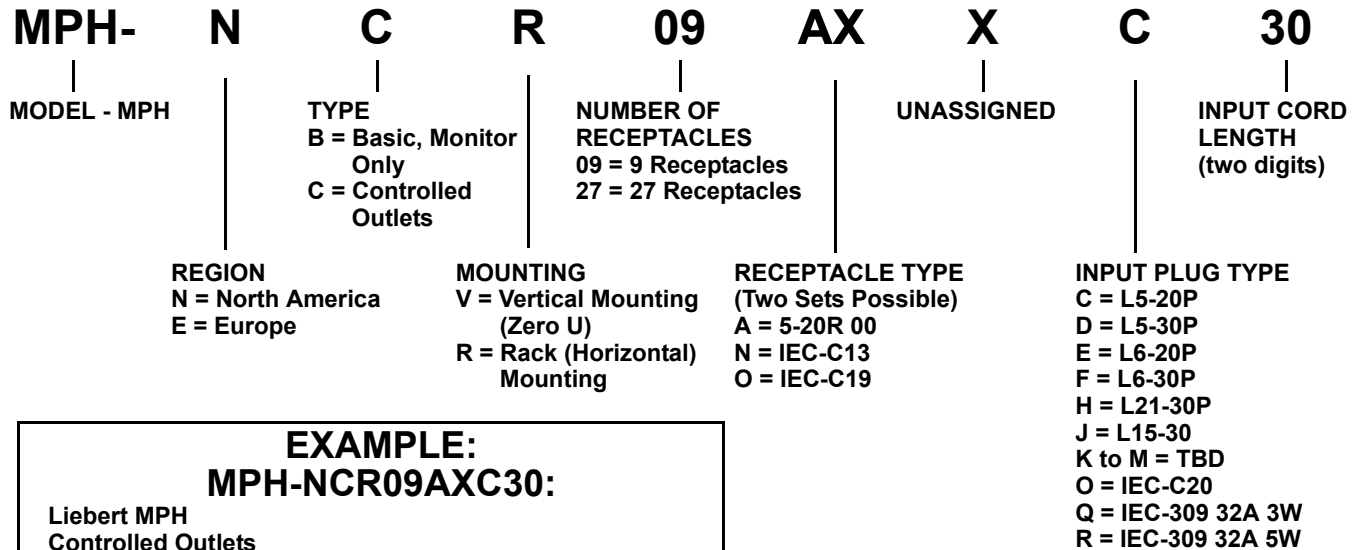

EXAMPLE:
MPH-NCR09AXC30:
Liebert MPH
Controlled Outlets
Rack Mounting
9 Receptacles
5-20R 00 Receptacle Type (no second set of receptacles)
—
L5-20P Plug
3m Input Power Cord

6.1 Agency Approvals

120V and 208V Single-Phase and Three-Phase Units

- UL 60950-1 Information Technology Equipment
- CAN/CSA-C22.2 No. 60950-1-03 Information Technology Equipment
- FCC, Title 47, Part 15 Subpart B for Class B operation as defined by ANSI Standard C63.4
- ROHS Compliant
- ISTA Procedure 1A and 2A

230V and 400V Three-Phase Units

- CE Markings Directive 93/68EEC according to the Low-Voltage Directive (LVD)
- CE Markings Directive 73/23/EEC
- Electromagnetic Compatibility (EMC) Directive 89/336/EEC
- European Directive 2002/95/EC on the restriction of the use of certain hazardous substances in electrical and electronic equipment (ROHS and WEEE Compliant)
- IEC 61709
- ISTA Procedure 1 A and 2A

6.2 Product Warranty Registration

To register for warranty protection, visit the **Service and Support** section of the Liebert Web site at:

www.liebert.com

Click on **Product Registration** and fill out the form.

NOTES

Ensuring The High Availability Of Mission-Critical Data And Applications.

Emerson Network Power, the global leader in enabling business-critical continuity, ensures network resiliency and adaptability through a family of technologies—including Liebert power and cooling technologies—that protect and support business-critical systems. Liebert solutions employ an adaptive architecture that responds to changes in criticality, density and capacity. Enterprises benefit from greater IT system availability, operational flexibility and reduced capital equipment and operating costs.

Technical Support / Service

Web Site

www.liebert.com

Monitoring

liebert.monitoring@emerson.com

800-222-5877

Outside North America: +00800 1155 4499

Single-Phase UPS & Server Cabinets

liebert.upstech@emerson.com

800-222-5877

Outside North America: +00800 1155 4499

Three-Phase UPS & Power Systems

800-543-2378

Outside North America: 614-841-6598

Environmental Systems

800-543-2778

Outside the United States: 614-888-0246

Locations

United States

1050 Dearborn Drive

P.O. Box 29186

Columbus, OH 43229

Europe

Via Leonardo Da Vinci 8

Zona Industriale Tognana

35028 Piove Di Sacco (PD) Italy

+39 049 9719 111

Fax: +39 049 5841 257

Asia

29/F, The Orient Square Building

F. Ortigas Jr. Road, Ortigas Center

Pasig City 1605

Philippines

+63 2 687 6615

Fax: +63 2 730 9572

While every precaution has been taken to ensure the accuracy and completeness of this literature, Liebert Corporation assumes no responsibility and disclaims all liability for damages resulting from use of this information or for any errors or omissions.

© 2009 Liebert Corporation

All rights reserved throughout the world. Specifications subject to change without notice.

® Liebert is a registered trademark of Liebert Corporation.

All names referred to are trademarks or registered trademarks of their respective owners.

SL-20827_REV01_08-09

Emerson Network Power.

The global leader in enabling *Business-Critical Continuity*.

■ AC Power

■ Embedded Computing

■ Outside Plant

■ Racks & Integrated Cabinets

■ Connectivity

■ Embedded Power

■ Power Switching & Controls

■ Services

■ DC Power

■ Monitoring

■ Precision Cooling

■ Surge Protection

EmersonNetworkPower.com

Business-Critical Continuity, Emerson Network Power and the Emerson Network Power logo are trademarks and service marks of Emerson Electric Co.

©2009 Emerson Electric Co.